



AIR HYDRAULIC PUMP 10 TONNE/WITH HOSE

MODEL NO'S: RE83/840.V2, RE83/840/CWH.V2

Thank you for purchasing a Sealey product. Manufactured to a high standard, this product will, if used according to these instructions, and properly maintained, give you years of trouble free performance.

IMPORTANT: PLEASE READ THESE INSTRUCTIONS CAREFULLY. NOTE THE SAFE OPERATIONAL REQUIREMENTS, WARNINGS & CAUTIONS. USE THE PRODUCT CORRECTLY AND WITH CARE FOR THE PURPOSE FOR WHICH IT IS INTENDED. FAILURE TO DO SO MAY CAUSE DAMAGE AND/OR PERSONAL INJURY AND WILL INVALIDATE THE WARRANTY. KEEP THESE INSTRUCTIONS SAFE FOR FUTURE USE.

Only fully trained and qualified persons should use this equipment. These instructions are not a substitute for user receiving full supervised training by a qualified person. It is important the user understands the applications, limitations and potential hazards of the product.



Refer to instruction manual



Wear eye protection



Wear protective gloves

1. SAFETY

- WARNING!** Ensure Health & Safety, local authority and general workshop practice regulations are adhered to when using this equipment.
- Familiarise yourself with product application and limitations, as well as the specific hazards peculiar to the pump.
- WARNING!** Disconnect the hydraulic pump from the apparatus before servicing or performing any maintenance.
- Maintain pump in good order. Replace/repair with *genuine parts only*. *Unauthorised parts may be dangerous and will invalidate the warranty.*
- Use qualified person to lubricate and maintain the hydraulic pump. **DO NOT** use brake fluid to top up hydraulic unit. Use Sealey hydraulic oil only.
- Keep the pump and treadle clean for best and safest performance.
- WARNING!** Ensure you know how much load you are pushing. Never exceed the maximum pushing capacity.
- The kit accessories may be used with other popular makes of kit.
- We recommend the use of BS approved safety impact goggles and heavy duty gloves when working with this pump. Both are available from your authorised Sealey stockist.
- Maintain correct balance and footing. Ensure the floor is not slippery and wear non-slip shoes.
- If working on an 'off centre' load, pump with care. If you feel undue resistance, stop and re-adjust the set-up.
- Ensure any hydraulic hoses are not bent or kinked but laid out correctly. Avoid damage to hoses (e.g. crushing/cutting).
- Keep non-essential persons away from the operating area. Be aware of the locations of other persons assisting you.
- DO NOT** operate the pump if any parts are damaged or missing as this may cause failure and/or personal injury.
- WARNING! DO NOT** use for any purpose other than for which it is designed.
- When not in use, place dust cap in end of hydraulic hose or cylinder and store in a safe, dry, childproof location.

2. INTRODUCTION

Suitable for use with SuperSnap® hydraulic ram as supplied with Model no. DZRE92/C Body Straightener and all body kits. Supplied without air hose. (Also available with hose - Order Model No. RE83/840/CWH.)

3. SPECIFICATION

Model no. RE83/840.V2/RE83/840/CWH.V2
 Max. air input 90-120psi
 Oil capacity 450cc
 Oil pressure 10000psi

4. OPERATION

4.1. SETTING UP

- 4.1.1. Remove pipe plug from hydraulic adaptor and connect a hose (Model RE83/840.V2 only)
- 4.1.2. Remove the shipping plug from the air inlet port and insert a 1/4" NPT quick release coupler (If not fitted).
- 4.1.3. Connect an air supply to the quick release air hose coupler and connect the hydraulic hose to the ram or device coupler.
- 4.1.4. To operate the pump for ram/device extension/actuation, depress the treadle at the air inlet valve end.
- 4.1.5. To retract the ram/device to the original start position, depress treadle end marked "RELEASE". Retraction will stop with load held, when pressure on treadle is removed. For fullest retraction continue to depress.

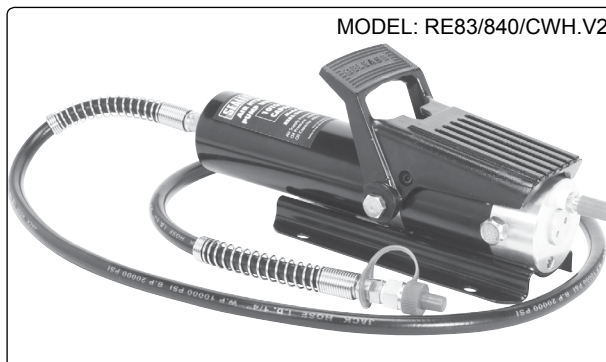

4.2. OPERATING REQUIREMENTS

- 4.2.1. For maximum performance and rated hydraulic pressure, air pressure should be 100psi minimum.
- 4.2.2. To ensure best performance the air supply equipment should include an air filter, regulator and lubricator. A minimum requirement is an air filter with the air compressor tank drained of water every day and a small quantity of lubricating oil into the air inlet each week.
- 4.2.3. Hydraulic output pressure can be controlled by regulating the air pressure. To determine the maximum hydraulic pressure multiply the regulated air pressure reading by 100.

5. MAINTENANCE

5.1. RELEASE VALVE ADJUSTMENT

- 5.1.1. Attach an air supply to the pump.
- 5.1.2. With a hex key loosen socket headed cap screw (Fig.2.) in treadle pivot boss two or three full turns.
- 5.1.3. With a screwdriver turn anti-clockwise the slotted head release valve (Fig.2. and Fig.3.) two full turns.
- 5.1.4. Lift the treadle at the air inlet end and depress the air valve button (Fig.1.) with your thumb.
- 5.1.5. Actuate the pump to build up pressure in the hose by depressing the treadle on to thumb and depressed air valve.
- 5.1.6. Using a screwdriver turn the slotted head release valve clockwise gently until resistance of the valve seat is felt. Excessive tightening will cause loss of pressure in hose.
- 5.1.7. Continuing to depress the air valve button with your thumb to obtain operating clearance between the treadle air valve and the release valve, tighten socket headed cap screw with a hex key through treadle pivot boss.
- 5.1.8. Release valve should now be correctly set.

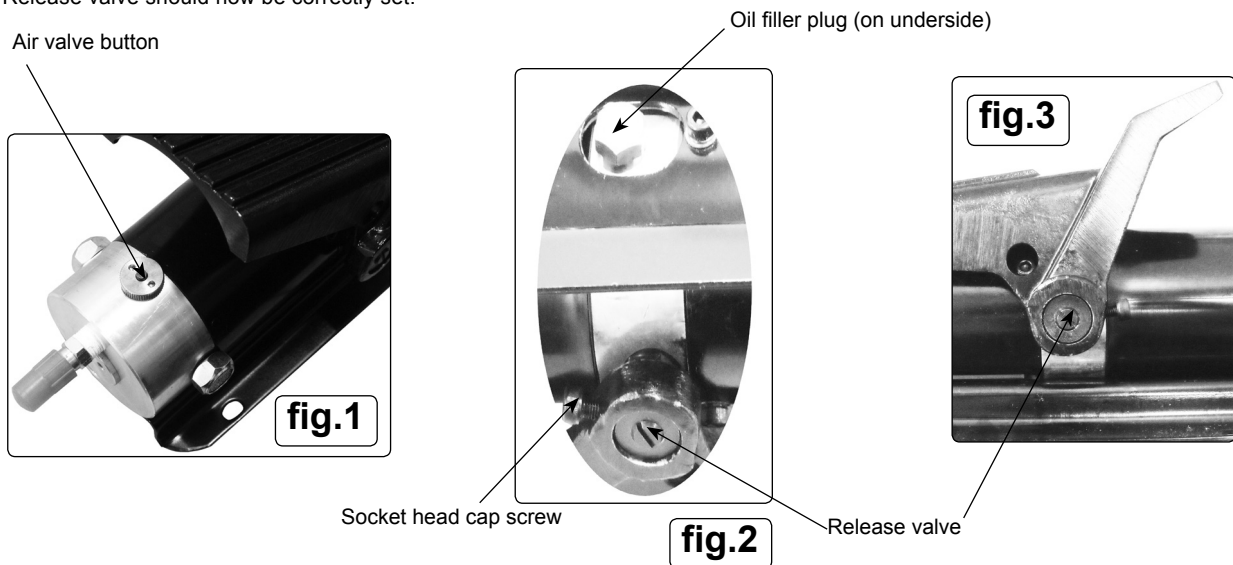

IMPORTANT: NO RESPONSIBILITY IS ACCEPTED FOR INCORRECT USE.

Hydraulic products are only repaired by local service agents. We have service/repair agents in all parts of the UK.

DO NOT RETURN PRODUCT TO US. Please telephone us on 01284 757500 to obtain the address and phone number of your local agent.

If product is under guarantee please contact your dealer.

De-commissioning Product

Should the product become completely unserviceable and require disposal, draw off the oil into an approved container and dispose of the product and the oil according to local regulations.



ENVIRONMENT PROTECTION

Recycle unwanted materials instead of disposing of them as waste. All tools, accessories and packaging should be sorted, taken to a recycling centre and disposed of in a manner which is compatible with the environment. When the product becomes completely unserviceable and requires disposal, drain any fluids (if applicable) into approved containers and dispose of the product and fluids according to local regulations.

Note: It is our policy to continually improve products and as such we reserve the right to alter data, specifications and component parts without prior notice. Please note that other versions of this product are available. If you require documentation for alternative versions, please email or call our technical team on technical@sealey.co.uk or 01284 757505.

Important: No Liability is accepted for incorrect use of this product.

Warranty: Guarantee is 12 months from purchase date, proof of which is required for any claim.

Sealey Group, Kempson Way, Suffolk Business Park, Bury St Edmunds, Suffolk. IP32 7AR



01284 757500



01284 703534



sales@sealey.co.uk



www.sealey.co.uk